

## TYPE C

TOWNHOUSE 4 - 7

Bedrooms	3
Bathrooms	2.5
Garage	1
Living	140.85m <sup>2</sup>
Balcony	3.42m <sup>2</sup>
Patio	10.50m <sup>2</sup>
<b>TOTAL</b>	<b>178.64m<sup>2</sup></b>

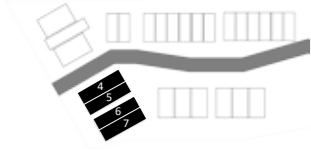

GROUND FLOOR



FIRST FLOOR



## TYPE D

TOWNHOUSE 8 - 13

Bedrooms	3
Bathrooms	2.5
Garage	1
Living	108.23m <sup>2</sup>
Balcony	8.75m <sup>2</sup>
Patio	10.20m <sup>2</sup>
<b>TOTAL</b>	<b>151.94m<sup>2</sup></b>

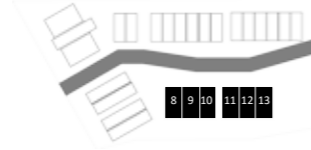

GROUND FLOOR



FIRST FLOOR



## TYPE E

TOWNHOUSE 14, 15,  
16, 21, 22, 27

Bedrooms	3
Bathrooms	2.5
Garage	2
Living	114.18m <sup>2</sup>
Balcony	2.15m <sup>2</sup>
Patio	11.50m <sup>2</sup>
<b>TOTAL</b>	<b>183.11m<sup>2</sup></b>

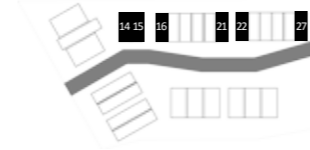

GROUND FLOOR



FIRST FLOOR



SECOND FLOOR



## TYPE F

TOWNHOUSE 17 -  
20, 23 - 26

Bedrooms	3
Bathrooms	2.5
Garage	2
Living	103.50m <sup>2</sup>
Balcony	2.08m <sup>2</sup>
Patio	8.28m <sup>2</sup>
<b>TOTAL</b>	<b>168.03m<sup>2</sup></b>

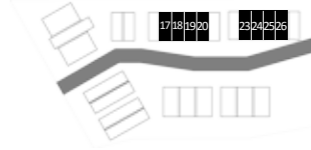

GROUND FLOOR



FIRST FLOOR



SECOND FLOOR

